

MAJOR COMPONENTS

ID	SIZE	DESCRIPTION (SOURCE)
CMM2	4 1/2" x 1"	Color MAXIMITE 2 (CIRCUITGRIMOS)
AMP	2 3/16" x 1 1/4" x 1/2"	DEOK SWX 5W PAM 8406 5V STEREO AMP (AMAZON)
1/0	2 3/16" x 2 9/16"	C2H-LONG RP: SCREEN TERMINAL BLOCK (AMAZON)
SPK	2" D x 1 1/4"	GIRFUN 2" 4Ω 3W SPEAKER (AMAZON)
USB-B	N/A	iGreeley 1' PANEL-MOUNT USB 2.0 B TO B (AMAZON)
VGA	N/A	SEETRONIC SVGA 15FF VGA TRASS-THROUGH (AMAZON)
FAN	1 9/16" x 1 9/16" x 3/8"	GEEKPI RASPBERRY PI QUIET FAN 40mm (AMAZON)

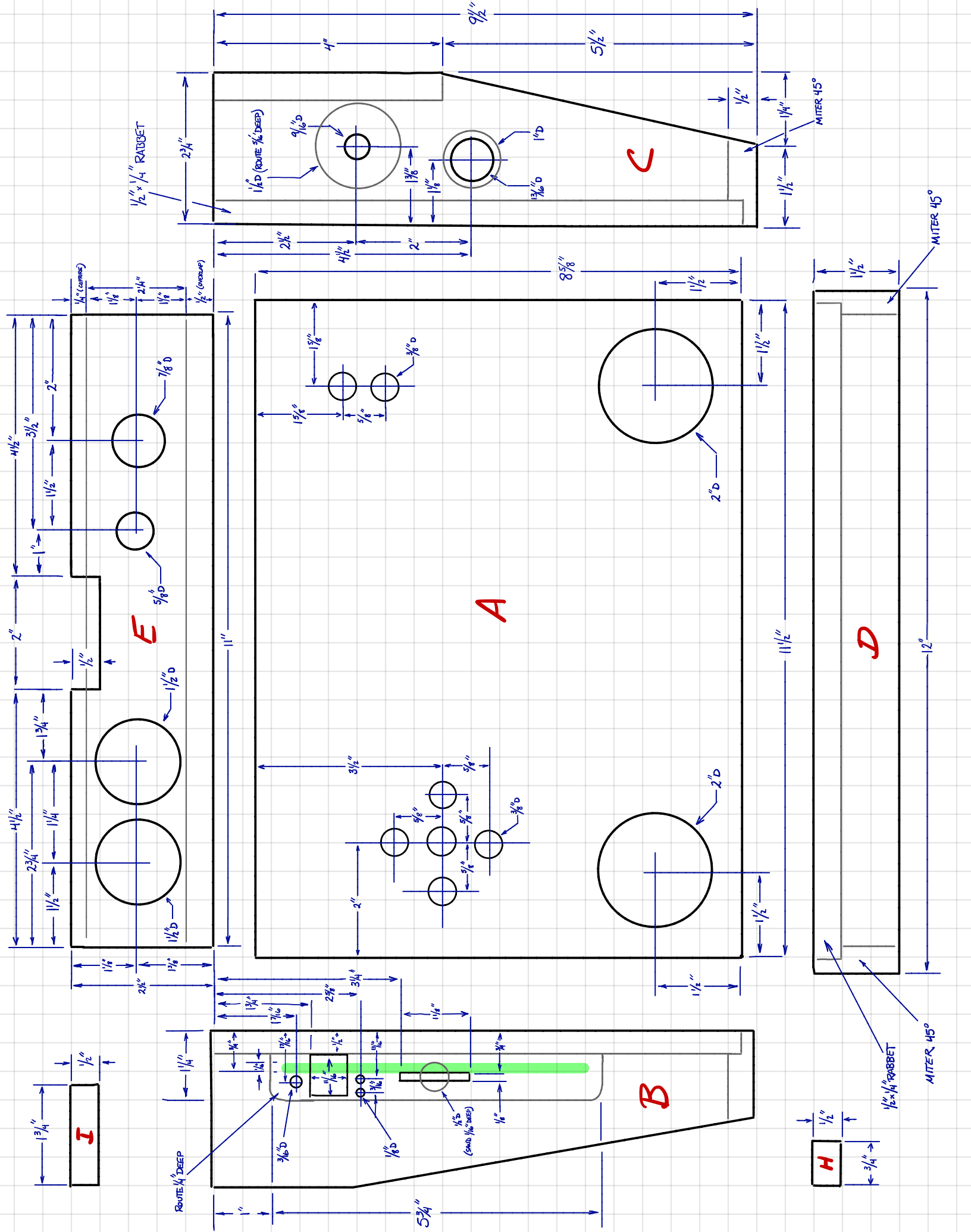

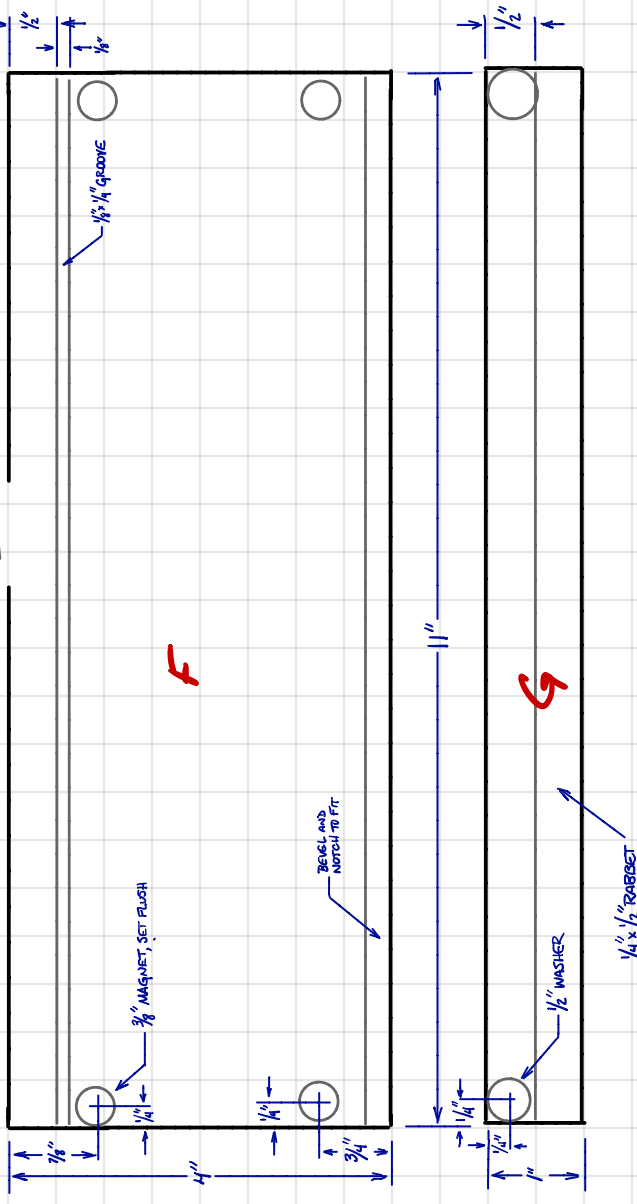
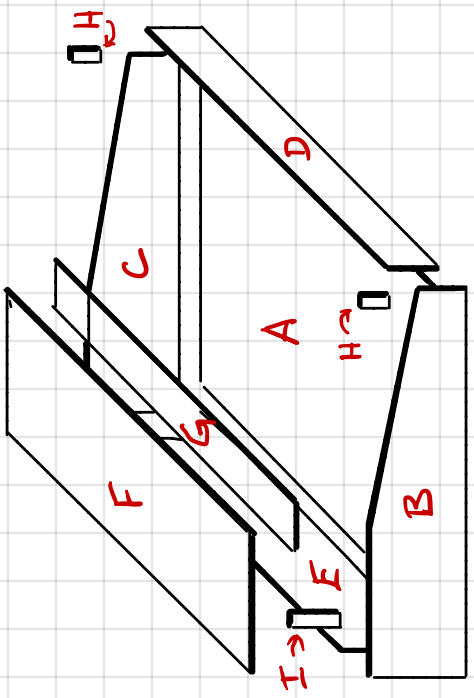

Cut List

ID	Item	Material	Qty	Dimensions	Notes	OK
A	Base	1/2" Ply	1	11 1/2" L x 8 5/8" W	Cut slightly oversize, trim for snug fit to keyboard with sides. Drill 2x2" holes for speakers, 9x1/4" for ventilation	CUT MILL
B	Left Side	1/2" Walnut	1	9 1/2" L x 3/4" W	Rabbet bottom 1/2 x 1/4" to fit A, miter front edge 45° to fit D Route recess for circuit board, drill and slot for SD, game controller, etc	CUT MILL
C	Right Side	1/2" Walnut	1	9 1/2" L x 2 3/4" W	Rabbet bottom 1/2 x 1/4" to fit A, miter front edge 45° to fit D Drill for power and volume switches	CUT MILL
D	Front	1/2" Walnut	1	12" L x 1 1/2" W	Miter edges 45° to fit B and C	CUT MILL
E	Back Panel	1/8" ply	1	11 1/2" L x 2 1/2" W	Cut notch for connectors, drill 2x1 1/2" for fans, 3/8" for USB, 7/8" for VGA Glue to A and H, top edge fits groove in F	CUT MILL
F	Top	1/2" Walnut	1	11 1/2" L x 4" W	Groove 1/8 x 1/4" in underside to fit E; drill 4x 3/8" for magnet catches Bevel front edge to top keyboard; notch to clear keyboard cable.	CUT MILL
G	Stretchers	1/2" Walnut	1	11 1/2" L x 1" W	Mount magnet washers to catch top F; affix to case with scrap blocks Rabbet as needed to seat keyboard height	CUT MILL
H	Front Glue Blocks	1/2" Walnut	2	1 1/2" x 1/2" x 1 3/4" L	Adjust length as needed to seat keyboard height	CUT MILL
I	Back Glue Blocks	1/2" Walnut	2	1 1/2" x 1/2" x 3/4" L	Mount magnet washers to catch top F Adjust length as needed to seat top floor, with sides B and C	CUT MILL